

Specifications

Aluminum Hinged profiles
System : SH-45
 Heavy-Duty and suitable for large openings.
 Weather resistant, durable and easy to maintain
 Curved surfaces with no sharp Edges.

Thickness : 1,6 mm

Mechanical properties

Thermal : T6
 Tension : 15
 Yield : 11
 Elongation : 8%

Chemical properties:

Aluminum: 97,65%
 Titanium 0,1 %
 Silicon : 0,3-0,6 %
 Iron : 0,35 %
 Manganese : 0,1 %
 Magnesium : 0,45-0,9%
 Chrome : 0,1 %
 Zinc : 0,1 %

Finish:

Electrostatic Powder Coating with the desired color



Glass Infill :- Single or Hermetically sealed Double Glass

6mm Clear Glass

Hermetic sealant

6mm Clear Glass

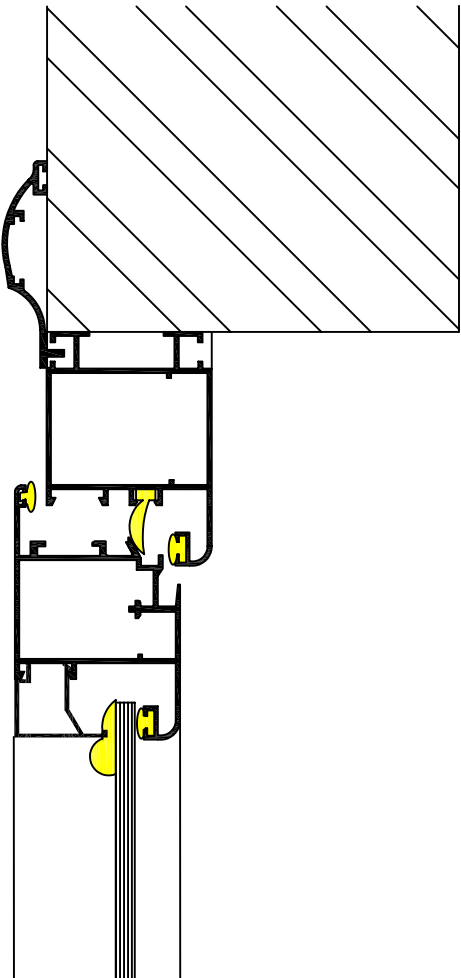
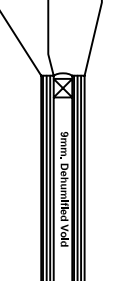

SH- Hinged system